

The Blake Library: Courtyard & Lobby

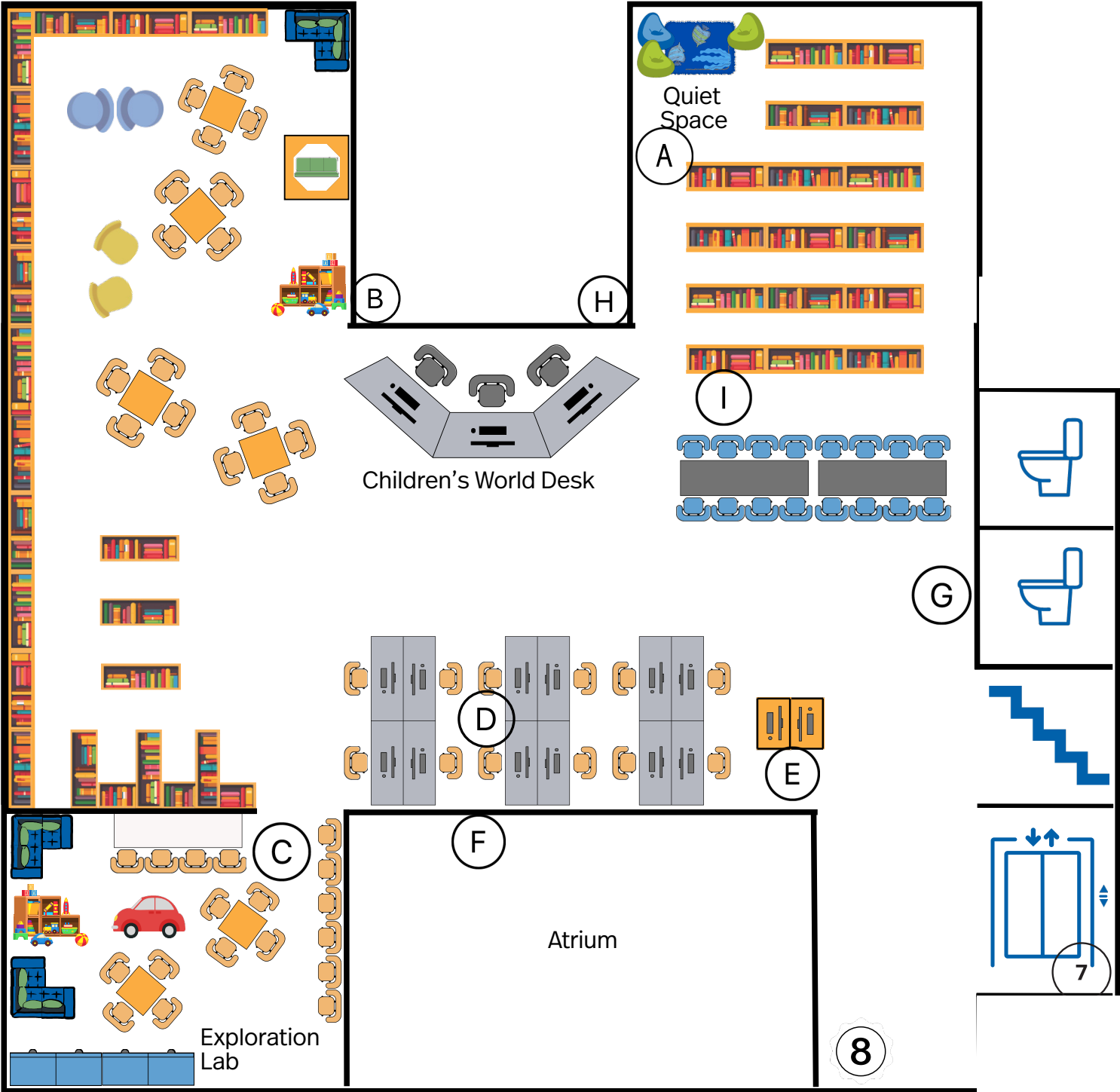

The Blake Library: Children's World



The Blake Library: Teacher's Guide

Entrance through courtyard (1). This area was created in January 2022 as a space for people to work, play, and meet with friends while still using the library! We have power outlets, tables and chairs, and games to encourage community connection before you even step inside the library building. The turtle mosaic (2) by Brenda Leigh is named Serenity.

In the lobby to the left of the die-cut station (3) is the Makerspace (4) where we keep a lot of our creative technology that you can use with your library card. Some of these items (the Cricut, sewing machine, and button maker) you can use without having to take a class, but the Glowforge does require a training session before you use it because it's a laser! Our 3D printer is always run by staff, and you can submit files for things that you'd like to have made and we will make it for you. People can also use this table for any other activity that they might need, like homework, meetings, phone calls, computer work, or large projects.

The Lego Wall (5) is by the stairwell. The mural was painted by a local artist named Anica Vin; can you find your favorite animal? She also painted the door to Bonnie's Bookstore (6), the used bookstore run by the Friends of the Martin County Library System here in our library.

At the entry to Children's World, be sure to visit our turtle sculpture, Sandy (7) by Barbara Baer, which is part of the art installation M.C. Turtles on Parade. This second floor has two parts: Children's World, and Administration. Administration (8) has offices and meeting rooms where people make sure that our library system is running smoothly. Children's World has all our books at a reading level up to 8th grade, and lots of internet computers, toys, games, and activities. We have many categories for books and materials here, and staff at the Children's desk will always be happy to help you find what you're looking for.

Let's play the BINGO game to discover more things in this space!

The Blake Library: Teacher's Guide

Bingo Location Key

- A. Comfy Reading Corner
- B. Reference
- C. Exploration Lab
- D. Catalog Computes
- E. Self-check Machines
- F. Sunshine State Book Display
- G. Bathrooms
- H. Story Express/STEAM Kits
- I. Graphic Novels



LIBRARY BINGO

**Explore Children's World
to find the items below!**

Comfy Reading Corner	Reference	Exploration Lab
Catalog Computers	Self- Check Machine	Sunshine State Book Display
Bathrooms	Story Express / STEAM Kits	Graphic Novels



LIBRARY BINGO

**Explore Children's World
to find the items below!**

Sunshine State Book Display	Self- Check Machine	Reference
Graphic Novels	Catalog Computers	Comfy Reading Corner
Exploration Lab	Bathrooms	Story Express / STEAM Kits



LIBRARY BINGO

**Explore Children's World
to find the items below!**

Reference	Comfy Reading Corner	Self- Check Machine
Catalog Computers	Bathrooms	Story Express / STEAM Kits
Sunshine State Book Display	Graphic Novels	Exploration Lab



LIBRARY BINGO

**Explore Children's World
to find the items below!**

Exploration Lab	Catalog Computers	Self- Check Machine
Graphic Novels	Reference	Sunshine State Book Display
Comfy Reading Corner	Bathrooms	Story Express / STEAM Kits



LIBRARY BINGO

**Explore Children's World
to find the items below!**

Exploration Lab	Bathrooms	Self- Check Machine
Sunshine State Book Display	Catalog Computers	Comfy Reading Corner
Graphic Novels	Reference	Story Express / STEAM Kits



LIBRARY BINGO

**Explore Children's World
to find the items below!**

Comfy Reading Corner	Graphic Novels	Reference
Self- Check Machine	Bathrooms	Sunshine State Book Display
Exploration Lab	Catalog Computers	Story Express / STEAM Kits



LIBRARY BINGO

**Explore Children's World
to find the items below!**

Comfy Reading Corner	Graphic Novels	Reference
Self- Check Machine	Bathrooms	Sunshine State Book Display
Exploration Lab	Catalog Computers	Story Express / STEAM Kits



LIBRARY BINGO

**Explore Children's World
to find the items below!**

Graphic Novels	Story Express / STEAM Kits	Reference
Catalog Computers	Self- Check Machine	Bathrooms
Comfy Reading Corner	Exploration Lab	Sunshine State Book Display



LIBRARY BINGO

**Explore Children's World
to find the items below!**

Sunshine State Book Display	Bathrooms	Graphic Novels
Catalog Computers	Exploration Lab	Comfy Reading Corner
Reference	Self- Check Machine	Story Express / STEAM Kits



LIBRARY BINGO

**Explore Children's World
to find the items below!**

Sunshine State Book Display	Catalog Computers	Exploration Lab
Reference	Self- Check Machine	Story Express / STEAM Kits
Graphic Novels	Bathrooms	Comfy Reading Corner