

ARTIST CALL OVERVIEW

SAILFISH SPLASH WATERPARK

Due February 10, 2012

Artist Services

The following activities may be required:

- Proposal Development
- Fabrication and Installation
- Photographic Documentation

Anticipated Art Project Schedule

- Artist Selection: February 24, 2012
- Design Completion: February 24, 2012
- Installation: To be determined on February 24, 2012

Art Project Budget

The total budget established for the project is **\$74,300**. The budget includes all costs to the artist: i.e., artwork proposals, artwork itself, mounting materials, installation, artwork shipping, insurance, travel and sales tax.

This call is broken down into five sections see Artist Call Details for more information.

Section One: Budget \$41,000

Entry Column, Entry wall, East and West Elevation Facades (2) and Tunnel Area

Section Two: Budget \$2,400

Food & Beverage area

Section Three: Budget \$20,600

Lazy River Area

Sections Four: Budget \$6,700

Competition Walls (2)

Section Five: Budget \$3,600

Competition Scoring Booth Photographic mural

Artist Eligibility

The project is open to any visual artist with experience implementing their ideas and work in coastal locations.

Preference for regional artists from Vero Beach South to West Palm Beach, Florida

Application Process

The application process is managed by Martin County Board of County Commissioners through the Department of Administration. The Martin County Public Art Site Selection Committee (PASSC), a committee of appointed citizens, serves as the recommendation committee with the Board of County Commissioners making the final selection(s). The following criteria will be considered:

1. Architectural enhancements shall be located in areas where residents and visitors live, work, or congregate and shall be highly visible and accessible.
2. The appropriateness of the work to the site, permanence of the work relative to environmental conditions, maintenance requirements and costs, and the enduring nature of the artistic statement.
3. The sensitivity of the work to the aesthetic and cultural traditions and the history of Martin County, Florida and also to the surrounding neighborhood's character.
4. The artist's biography and resume, examples of existing works, technical competency, similarity to existing works of art and the following basics: form, texture, color, clarity, line and medium.

Application Requirements

The information and documentation below must be postmarked or arrive at the Martin County Administration Building before 5:00 PM on the stated deadline.

- 1) Artist's Vision: A sketch or paragraph illustrating the artist's vision of the project and how it would fit within the site.
- 2) Statement: A one-paragraph maximum demonstrating the relationship between the work submitted in slides and the specific project. Be sure to indicate if a specific work is for sale.
- 3) Resume: A current and professional resume, emphasizing public art experience and public commissions (if any).
- 4) Images: A maximum of 10 images may be sent and must represent completed artworks or projects completed during the last five years. Images may be sent in one of the two formats noted below:
 - a) Slides: 35mm 2" x 2" slides of, in a 9" x 11" slide sheet. . Slides must be labeled with slide number (1-10), artist's name and title of work. Slides must also have a dot in the lower left-hand corner to facilitate loading into carousels.
 - b) Digital Images: JPG files, 765 x 765 pixels, SRGB color setting (not to exceed 8" in either dimension, height or width). Each individual image must

be saved under the artist's last name and the corresponding number as noted in the annotated lineage list. Write artist name on single CD-Rom and mail with accompanying information. No e-mail submissions will be accepted. ***Please test opening the files on different computers. Files that cannot be opened cannot be reviewed!***

- 5) Annotated Slide/Image List. An identification sheet which gives the specific project number and name, the artist's name, address and phone number, and, for each slide/image, the corresponding slide/image number (1-10), title of work, medium, dimensions, date of work, price of work and if applicable the name and location of the commissioning public agency.
- 6) SASE. A self-addressed, stamped envelope for the return of slides or CD-Rom.

Deadline: February 10, 2012

Send or Deliver to:

Linda Fasano, AIPP Coordinator
Martin County Administrative Center
2401 SE Monterey Road
Stuart FL 34996

Questions:

Contact: Linda Fasano

[E-mail: lfasano@martin.fl.us](mailto:lfasano@martin.fl.us)

Website for Arts in Public Places [www.martin.fl.us Administration/ Arts in Public Places](http://www.martin.fl.us/Administration/Arts%20in%20Public%20Places)

Martin County, Florida

Located on Florida's Treasure Coast, Martin County has an abundance of natural beauty, beginning at its coastline where one may witness a giant sea turtle lumbering ashore to lay its eggs in the sand. The rivers are wild and scenic, filled with a vast array of tropical flora, and fauna. Preservation and appreciation of the untouched splendor is of utmost importance to the people who live, work and vacation in the area. The county seat is Stuart. The population is approximately 146, 318. The West Palm Beach Airport is a 45-minute drive to Stuart and Jensen Beach.

Martin County Art in Public Places Program

The program was established in 1997 and has completed 13 projects. Artists commissioned by the Martin County include Chris Dutch of Charleston, West Virginia, Carol May & Tim Watkins of Brooklyn, New York, Terry Thommes, Stuart, Florida, and Amy Koontz Knippel of Gainesville, Florida, Brenda Leigh of Stuart Florida, Susan Lampert of Jupiter Florida and Mia Lindberg of Jensen Beach Florida.

ARTIST CALL DETAILS SAILFISH SPLASH WATERPARK



The Sailfish Splash Waterpark at Martin County is designed to meet the recreation, fitness, physical development, and competitive swimming and diving needs of the community.

The complex, located in Stuart on Willoughby Blvd. just north of Indian Street in Stuart Florida, will provide a unique and rich venue for aquatics recreation for all ages, which has been and continues to be an integral part of Martin County's character, be it swimming at the beach, playing in the backyard pool, or boating in the St. Lucie Inlet.

As a part of the Parks and Recreation Master Plan and funding from the Half-cent Sales Tax, residents of Martin County identified an aquatics complex as a top priority for Martin County.

Artists Call: Murals

These projects target all age groups from toddler through elementary school and families on the Recreation side and middle, high school, and college students. including travel teams on the competition side.

Martin County is rich with an abundance of wildlife, rivers, estuaries, with Lake Okeechobee to the west and the Atlantic Ocean on the east. Native marine wildlife, reefs, trees, mangroves and plants should be a focus in the designs, historic native reference a key.

Medium:

Section One: Murals painted light stucco surface

Section Five: Photographic mural on the scoring booth

SECTION ONE

Entrance: West Elevation Marine Life and Coral Reef

Wraps around to Competitive Side: East Elevation
Marine Life and Corals

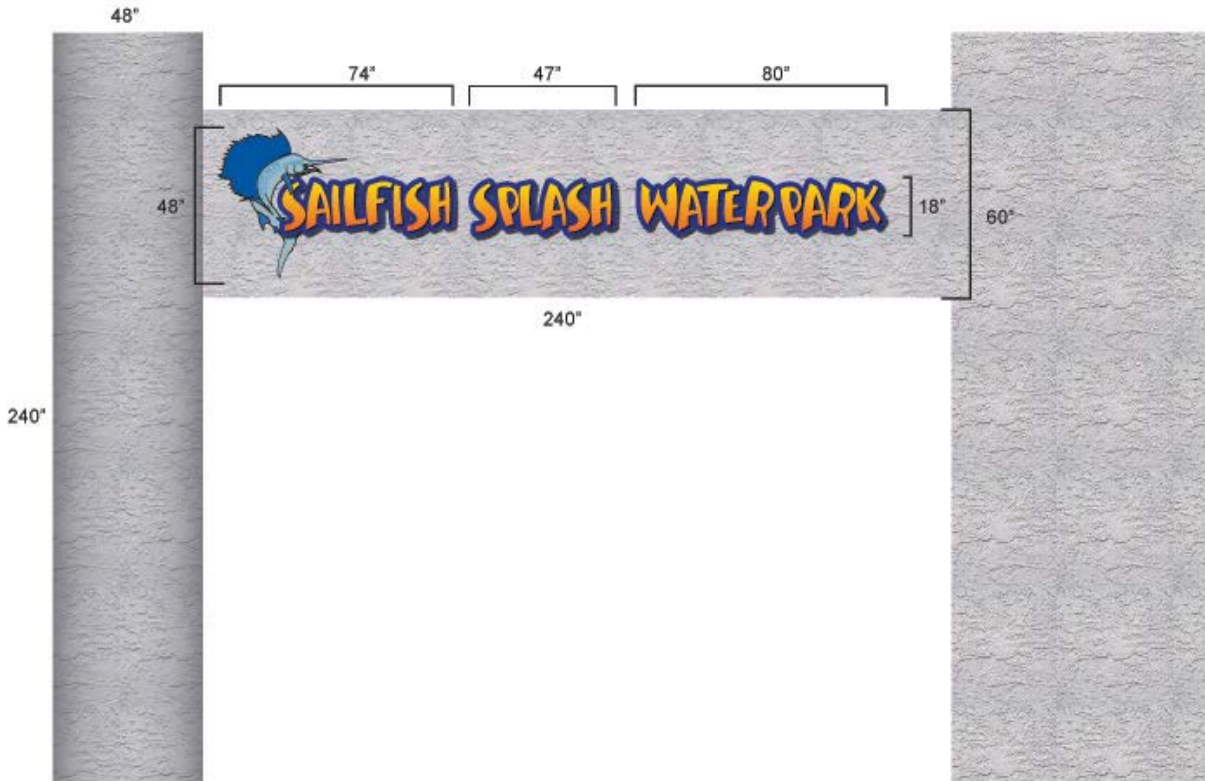

Upon entering the facility a large column adjacent to the building and drop off area, supports the signage for the facility. This column should reference to visuals depicting Coral Reef native species.

Approximate diameter of column 4' X 24' high

Lower 2/3 coral detail to remaining 1/3 water color.

Ticket Windows

Beneath the ticket windows, a small area of coverage with marine water-themed visual. This small area wraps around the corner into the facility (a visual to aid traffic flow into the facility).

Approximate 4-6' wide X 4-6' high.



The Ticket Booths are the three windows to the right in the photo above.

***keep in mind small child for heights on visuals

Curved Façade East and West

Continuing with the same marine underwater theme across the curved façade over the lockers and restrooms, stopping at the end of the curve (stops at lifeguard room beneath facade).

Approximate 70' wide X 6' high



Curved facade wraps east elevation around to Competition Area. It is the area directly above the vertical pillars.

Approximate 40' wide X 6' high



Note: scaffolds required

Tunnel Area

The Tunnel Area is the entrance between the Competition Area and the Recreation Area of the facility that will encompass the entire walkway including the walls and ceiling. This mural will give the illusion of swimming underwater in the Atlantic Ocean a mix of actual native species with a twist of fun. (for instance a Cross-eyed blowfish) the idea is to create a fun atmosphere with local native elements.

Approx. 30' wide X 8' high (starts 24" from floor up)
37' wide X 8' high (starts 24" from floor up)
Ceiling 16 wide x 37 long



***Remember this is a tunnel, the walls wrap into the ceiling
***Keep in mind small child for height on visuals



Above the tunnel entrance is one large square area where a visual depicting Sailfish Splash Waterpark is to be incorporated into the design.

Realism focus here.

SECTION TWO

Food/Beverage Room: This room encompasses only one wall

Approximate 12' wide X 10' high

Supplies (sunscreen, sunglasses, etc.) and memorabilia (T-shirts, ball caps, etc.) are sold in this room. Across the room from where the sales and food service occurs is a wall for a mural.

SECTION THREE

Lazy River Area: The Lazy River Mural wall with a focus on life in and on the St. Lucie River and the Estuaries. (i.e. manatees, alligators, plants, mangroves and fish). This wall wraps the north end of the entire Lazy River.

Approximately 78' long/wide by 6' high at the highest point. This wall is a handicap ramp wall that grades down to ground level

A second wall approximately 26' wide by 6' high hides the area where inner tubes for riding the Lazy River are stored. Low to the ground plantings will be at the base of this wall but the balance is exposed to patrons riding along the Lazy River and those sunning themselves on an island area which the Lazy Rivers surrounds.

Realism focus here.

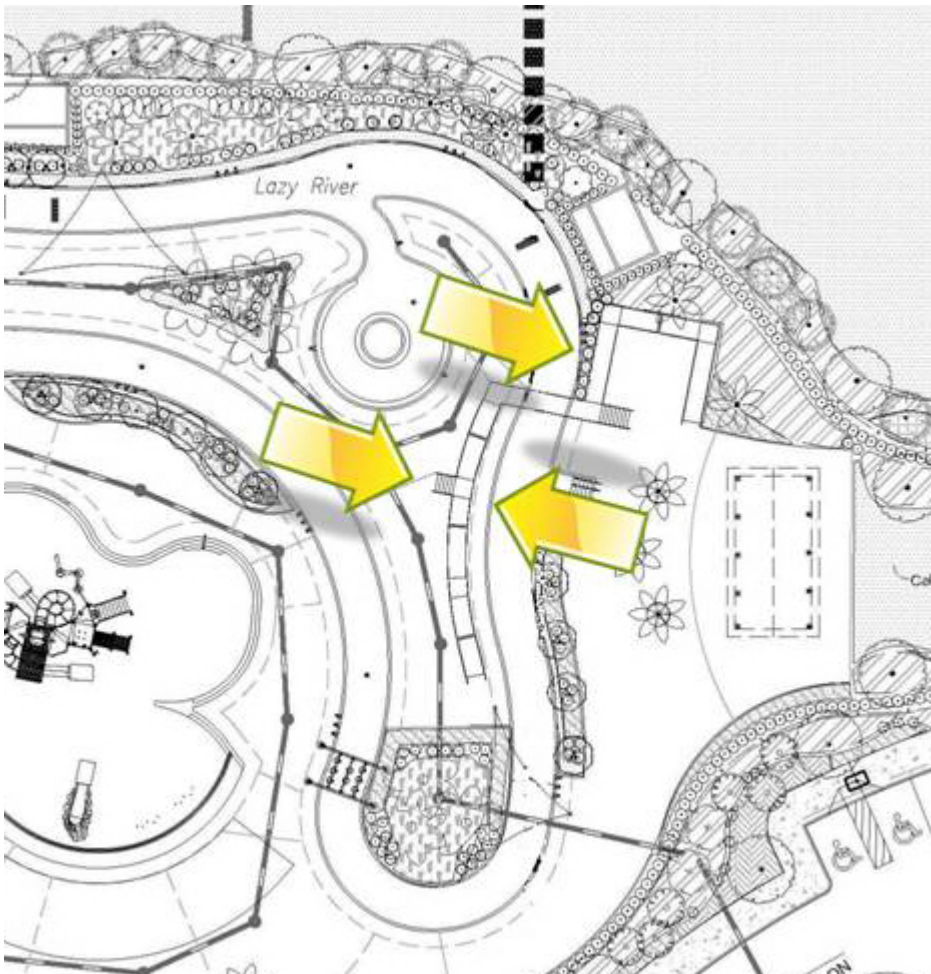

SECTION FOUR
Competition Pool

Walls adjacent to bleachers

This area will include two murals to encompass a sleek contemporary race atmosphere.

West Wall is approximately 36' wide X 6' high



The East Wall is approx 20' wide X 6' high



SECTION FIVE

Scoring Booth



Realism/photographic mural is suggested.

Approximately 12' wide X 12' high (includes a window approximately 10' wide X 3' high)

- Scaffolds will be needed.

- Photographic/Realism is focus here with a of photographic mural.
- All work must be sealed, easily cleaned, UV protective paints, withstand chlorine water and heavy traffic.
- All measurements are approximate, taken from blueprints, not actual size.

Additional comments on the facility for Artist reference

The Sailfish Splash Waterpark at Martin County will include:

- 1) A two-acre recreational area with attractions, including:
 - a) 750-foot lazy river with spray play devices;
 - b) Two 40-foot tall slides:
 - i) Open flume slide 298 feet long,
 - ii) Closed flume slide 253 feet long;
 - c) Leisure Pool – 7,326-square feet,
 - i) Zero-depth entry,
 - ii) Floor jets/sprays (20),
 - iii) Participatory water sprays (3),
 - iv) Perimeter water sprays (14),
 - v) Beached Boat Slide for Tot use,
 - vi) Play Structure with,
 - (1) 4 slides,
 - (2) 78 water jets and 54 play features,
 - (3) 300 Gallon tipping bucket;
 - d) Shaded picnic areas;
 - e) Dry playground;
 - f) Plenty of deck space;
 - g) WiFi;
 - h) Lounge chairs.

- 2) A 25-yard heated and cooled lesson pool designed to support private and group swim lessons for all ages, physical therapy, senior aquacize and lessons for special needs individuals. Features include:
 - a) Large step entry;
 - b) Depth ranging from 3½ feet to 6 feet;
 - c) Fully accessible entry;
 - d) Shade canopies;
 - e) Lifts for individuals with physical disabilities.

- 3) A 50-meter by 25-yard 7-foot deep (FINA standards) heated and cooled competitive swimming and diving pool that will support USA Swimming-sanctioned short-course and long-course swim meets, FHSAA swim and diving meets and water polo competitions. Features include:

- a) An advanced computerized scoring and timing system that can support simultaneous 10-lane events, diving and team scores, as well as video and instant replay;
 - b) 40-foot deck space around all sides;
 - c) Bleacher seating for 800;
 - d) Lifts for individuals with physical disabilities;
 - e) Locker, changing, shower, and restroom facilities.
- 4) A 7,000 square-foot support facility, complete with:
- a) Café/concession area with indoor seating;
 - b) Parent viewing room for lesson pool;
 - c) Multi-purpose rooms for instructional needs, meetings, and parties;
 - d) Oversized restrooms and locker rooms;
 - e) Family changing rooms;
 - f) Swim meet scoring;
 - g) Manager's office.
- 5) Green water treatment, heating and cooling.
- 6) Extensive parking.